

CREATE
YOUR STYLE
with SWAROVSKI ELEMENTS



INSTRUCTION PACKAGE

PENDANT “PEGASUS”

INSTRUCTION PACKAGE

PENDANT “PEGASUS”

SWAROVSKI ELEMENTS

Article	Product Group	Article No.	Amount	Size	Color	Color Code
	Beads	5000	7 pcs.	6 mm	Light Azore	361
	Beads	5000	2 pcs.	6 mm	White Alabaster	281
	Beads	5000	1 pc.	8 mm	Pacific Opal	390
	Beads	5000	1 pc.	8 mm	White Alabaster	281
	Beads	5328	6 pcs.	5 mm	Chrysolite	238
	Pendants	6150	1 pc.	50 mm	Mosaic Pacific Opal	754

Supplies & Tools

Supplies

17x Head pin, silver
 31x Jump ring, silver, Ø 12 mm
 17x Jump ring, silver, Ø 6 mm
 Ribbon satin, grey, Ø 2 mm, 90 cm

Tools

Chain nose pliers
 Flat nose pliers
 Round nose pliers
 Side cutter
 Tweezers

Level of design: INTERMEDIATE

Have also a look at the **text instruction** at the last page!

STEP 1

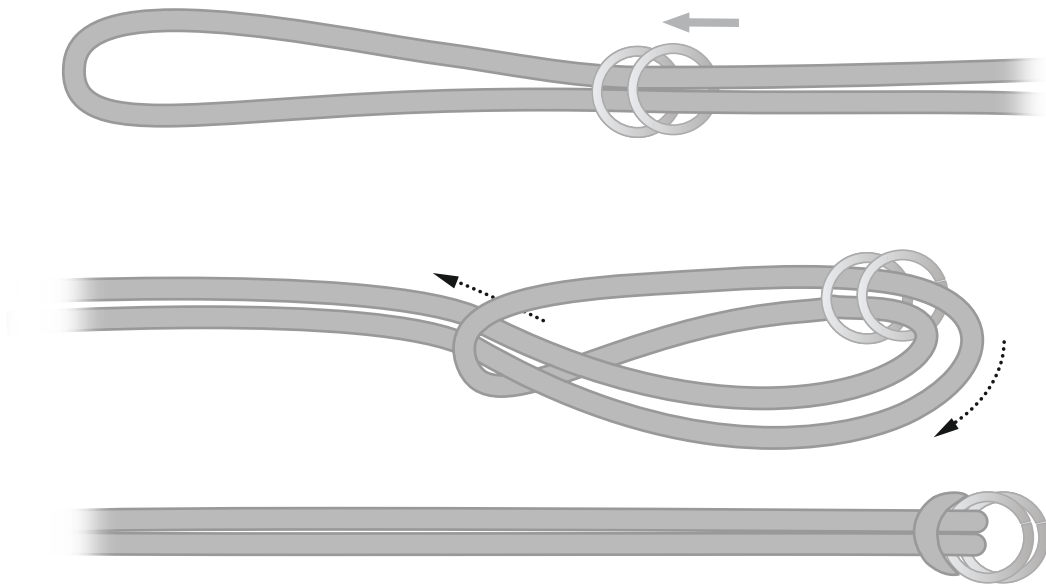

STEP 2

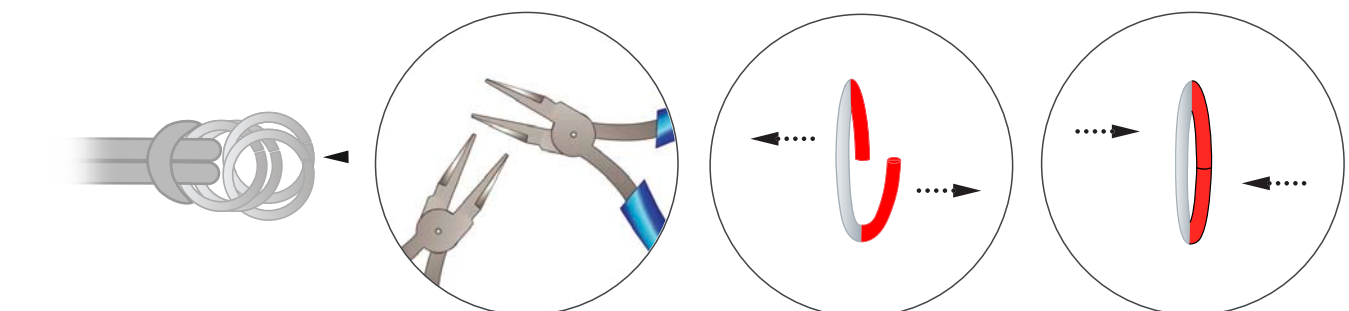

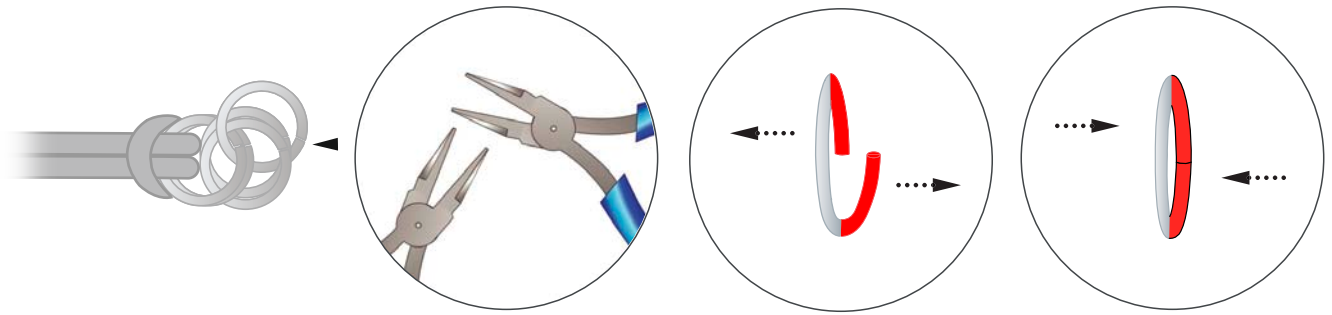

Repeat x1:

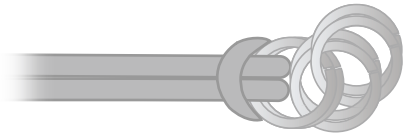

STEP 3

Repeat step 2:

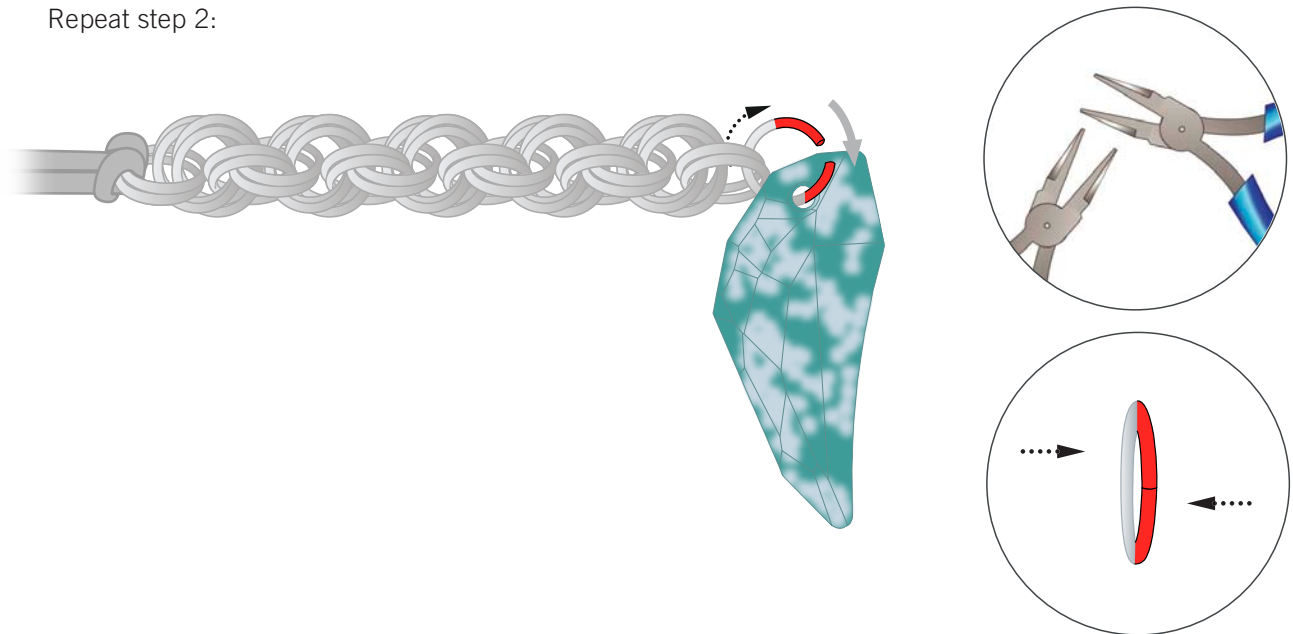

STEP 4

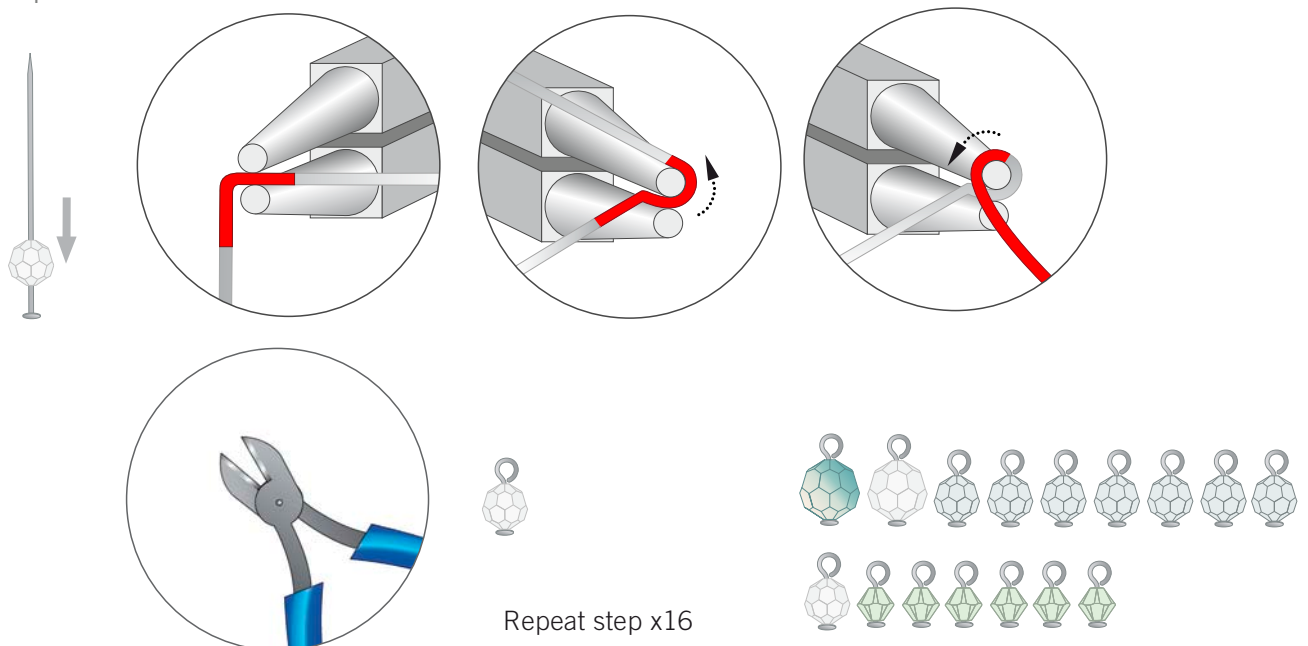

STEP 5

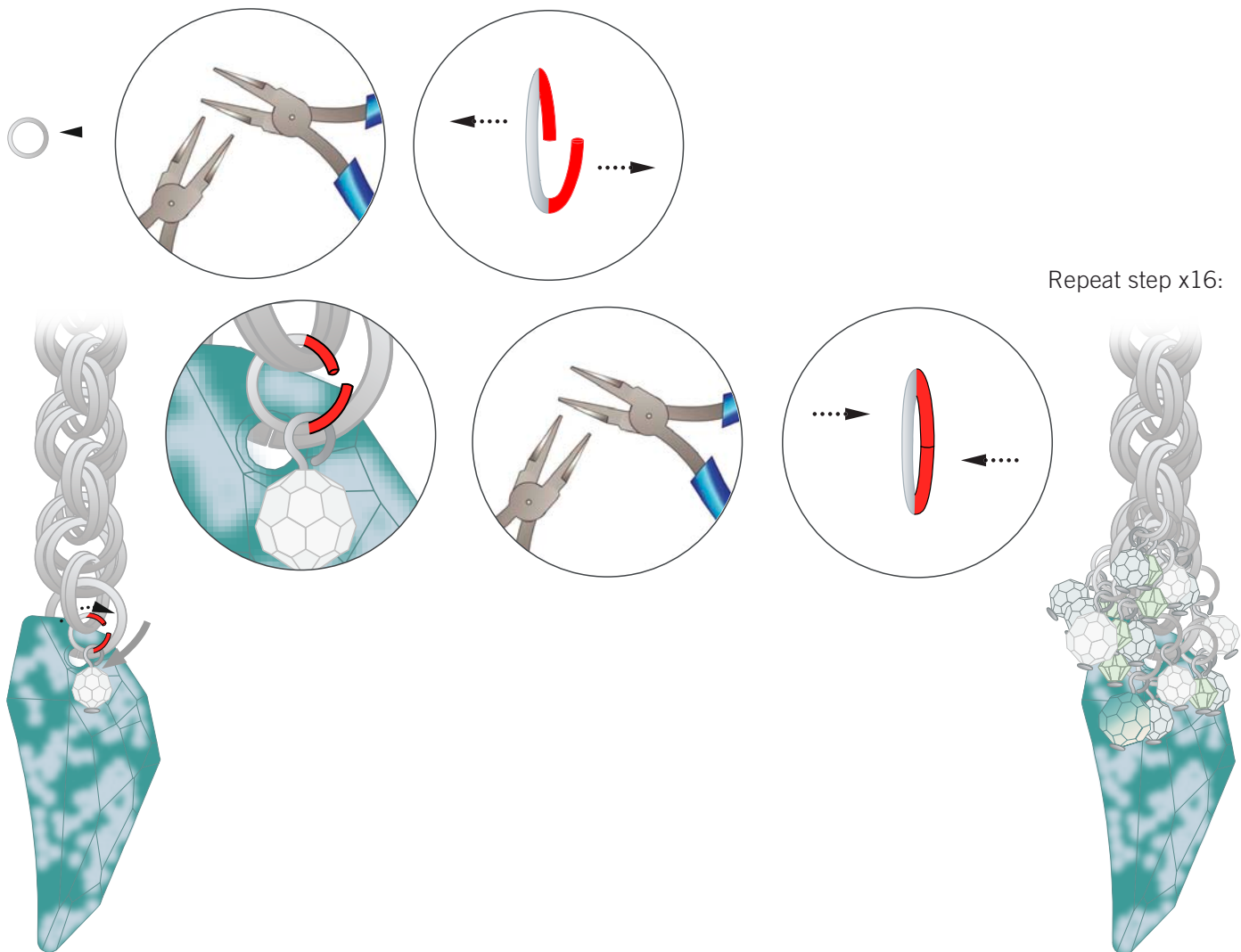

STEP 6

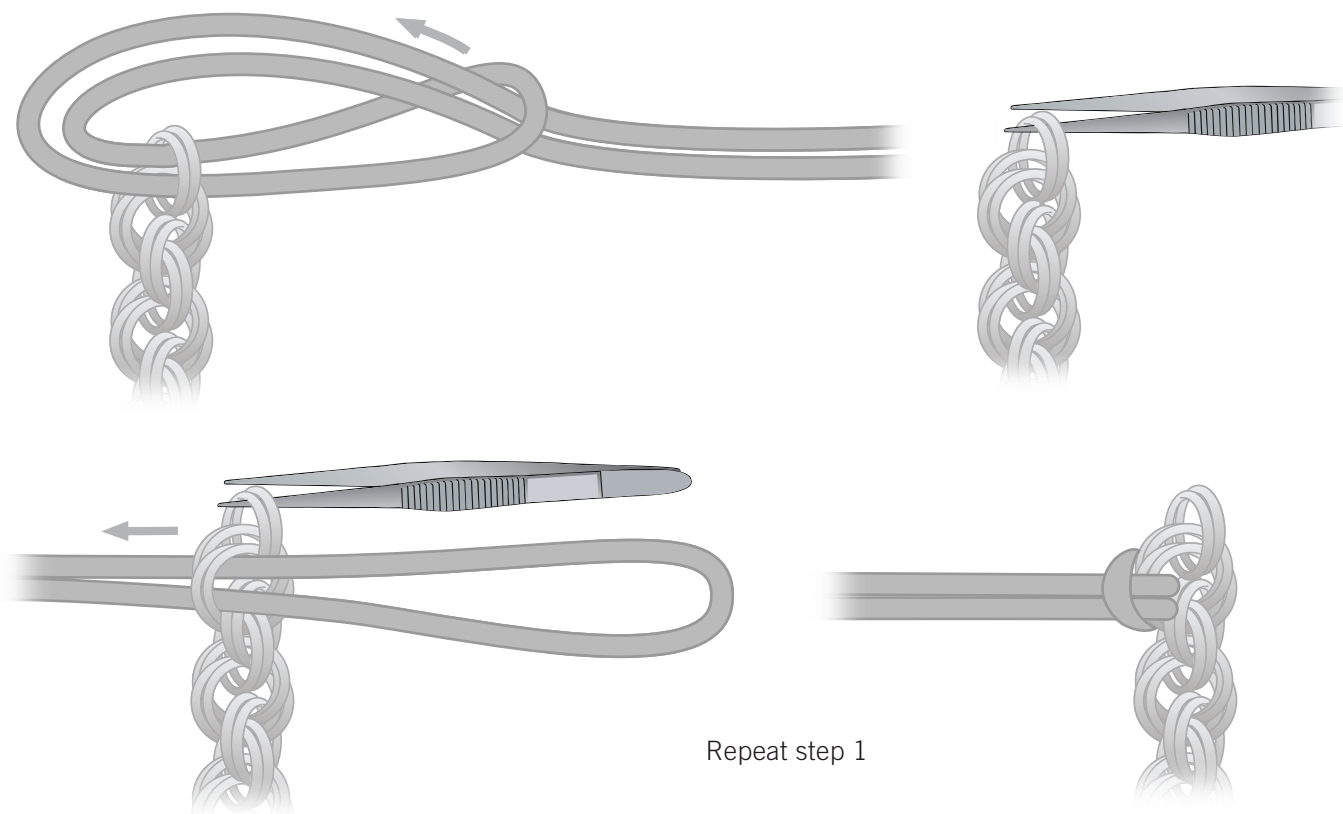

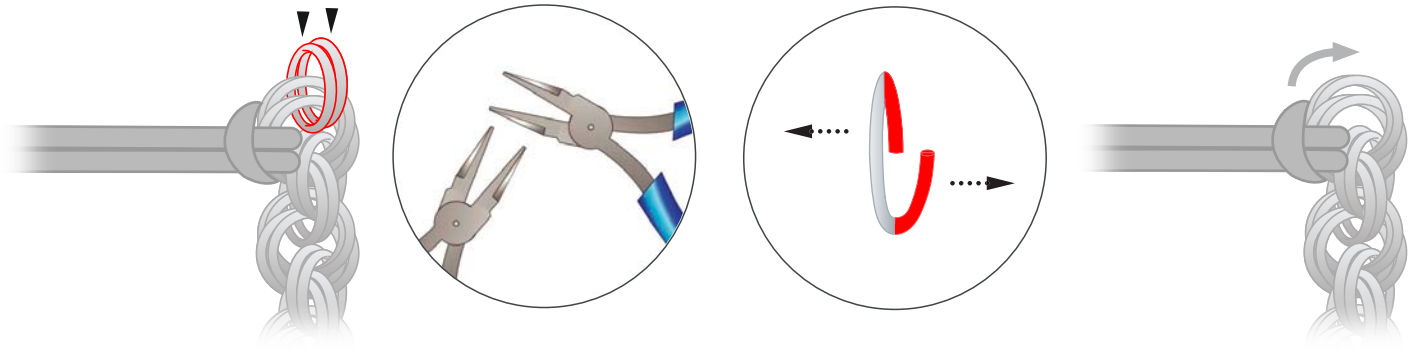



INSTRUCTION PACKAGE

PENDANT “PEGASUS”



- STEP 1: Take 2 closed 12mm jump rings and attach the satin ribbon onto them as you see in the illustration.
- STEP 2: Open two 12mm jump rings and attach them to the first two jump rings. Take another 12mm jump ring and hang it onto the 4 others as you see in illustration. Repeat this step with one more 12mm jump ring (see illustration).
- STEP 3: Repeat step two 9 times and hang another 12mm jump ring with the Swarovski Pendant article 6015/A Mosaic Pacific Opal onto last 2 jump rings.
- STEP 4: Take a head pin and slide on one Swarovski Bead article 5000 and form a loop with round nose pliers and cut off excess with side cutter. Repeat this step 16 times with the other Swarovski Beads article 5000.
- STEP 5: Open 17 6mm jump rings with flat nose pliers and hang the Swarovski Beads with onto the 12mm jump rings of the Swarovski Pendant. See the illustration for correct positioning.
- STEP 6: Remove satin ribbon and hold the two jump rings with tweezers. Insert satin ribbon into the 4 jump rings as you see in illustration and repeat step 1 to fix the satin ribbon. Remove the upper two jump rings with pliers.